

FABRICATED TEE STRAINERS

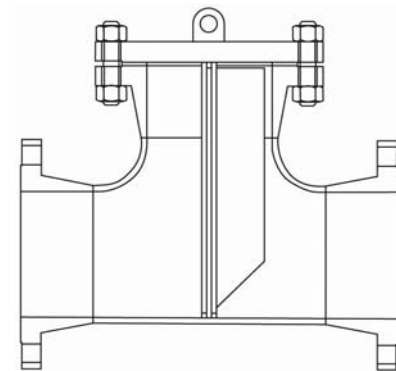

Model 150/300/600TFBSW Steel
Model 150/300/600TFSSBW Stainless Steel

FEATURES

SCREENS: 1/8" perforated type 304 stainless steel on sizes 2" to 24". Other perforations, meshes and materials are available upon request

CONSTRUCTION: Standard units are fabricated with weld-neck flanges in standard pressure classes up to 600 lb. Other flange styles and welded connections are available per your specifications

CODES: Fabricated to ASME B31.1, ASME B31.3 and/or ASME Section VIII, Div. 1. Latest Revision

OPTIONS

- Standard in sizes 2" through 24". Larger sizes available. Consult factory
- Dimensions can be modified to suit customer requirements
- End connections available in RF flanges, RTJ flanges or butt weld.
- Various body and screen materials and coatings are available.
- Special screen open area ratios
- Quick-opening cover
- Cover lifting davits
- Upstream and downstream screen supports allow for bi-directional flow
- Reduced inlets and outlets
- Self-Flushing assembly
- Vent and pressure differential connections

PRESSURE AND TEMPERATURE RATINGS

Model	Body Material	Maximum Design Pressure M.A.W.P. at 100°F	Low Temperature Limit – M.D.M.T
150TFBSW	Carbon Steel	285 psig	-20 °F
150TFSSBW / 150TFSS6BW	304 / 316 Stainless Steel	275 psig	-20 °F (Optional -425 °F available)
150TFSSLBW / 150TFSSL6BW	304L / 316L Stainless Steel	230 psig	-20 °F (Optional -425 °F available)
300TFBSW	Carbon Steel	740 psig	-20 °F
300TFSSBW / 300TFSS6BW	304 / 316 Stainless Steel	720 psig	-20 °F (Optional -425 °F available)
300TFSSLBW / 300TFSSL6BW	304L / 316L Stainless Steel	600 psig	-20 °F (Optional -425 °F available)
600TFBSW	Carbon Steel	1480 psig	-20 °F
600TFSSBW / 600TFSS6BW	304 / 316 Stainless Steel	1440 psig	-20 °F (Optional -425 °F available)
600TFSSLBW / 600TFSSL6BW	304L / 316L Stainless Steel	1200 psig	-20 °F (Optional -425 °F available)

All models will be designed to the maximum design pressure unless alternative design conditions are specified. In some cases a cost savings may result if lower design conditions are acceptable.

Lower and higher M.D.M.T rating is available upon request.

Colton has a policy of continuous product research and improvement and reserves the right to change design and specifications without notice



FABRICATED TEE STRAINERS

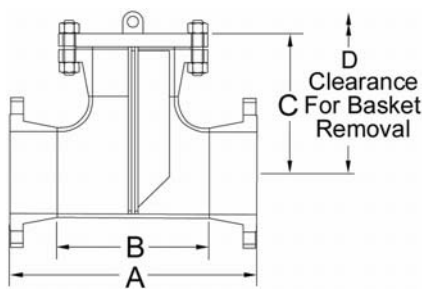

STYLE 1

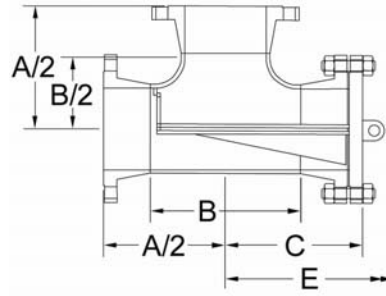

STYLE 2

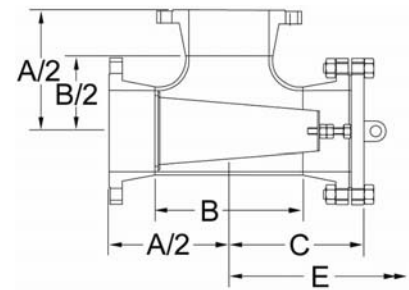

STYLE 3

DIMENSIONS AND WEIGHTS FOR SERIES 150T

Size		DIMENSIONS										Weight	
		A		B		C		D		E			
mm	in	mm	in	mm	in	mm	in	mm	in	mm	in	kg	lbs
50	2	254	10	127	5	146	5-3/4	279	11	318	12-1/2	13	28
80	3	311	12-1/4	172	6-3/4	179	7-1/16	349	13-3/4	387	15-1/4	24	52
100	4	362	14-1/4	210	8-1/4	205	8-1/16	413	16-1/4	467	18-3/8	36	79
125	5	425	16-3/4	248	9-3/4	237	9-5/16	489	19-1/4	549	21-5/8	48	105
150	6	464	18-1/4	286	11-1/4	257	10-1/8	540	21-1/4	606	23-5/8	64	140
200	8	559	22	356	14	308	12-1/8	660	26	737	29	104	230
250	10	635	25	432	17	348	13-11/16	762	30	851	33-1/2	148	325
300	12	737	29	508	20	400	15-3/4	889	35	991	39	227	500
350	14	813	32	559	22	441	17-3/8	991	39	1092	43	322	710
400	16	864	34	610	24	468	18-7/16	1067	42	1168	46	390	860
450	18	965	38	686	27	552	20-9/16	1194	47	1308	51-1/2	465	1025
500	20	1051	41-11/32	762	30	568	22-3/8	1305	51-3/8	1432	56-3/8	613	1350
600	24	1168	46	864	34	632	24-7/8	1473	58	1600	63	953	2100

DIMENSIONS AND WEIGHTS FOR SERIES 300T

Size		DIMENSIONS										Weight	
		A		B		C		D		E			
mm	in	mm	in	mm	in	mm	in	mm	in	mm	in	kg	lbs
50	2	267	10-1/2	127	5	156	6-1/8	292	11-1/2	330	13	19	42
80	3	330	13	172	6-3/4	194	7-5/8	368	14-1/2	406	16	33	72
100	4	381	15	210	8-1/4	222	8-3/4	432	17	486	19-1/8	57	125
125	5	445	17-1/2	248	9-3/4	257	10-1/8	508	20	568	22-3/8	73	160
150	6	483	19	286	11-1/4	278	10-15/16	559	22	625	24-5/8	102	225
200	8	578	22-3/4	356	14	330	13	679	26-3/4	756	29-3/4	159	350
250	10	667	26-1/4	432	17	381	15	794	31-1/4	883	34-3/4	225	495
300	12	768	30-1/4	508	20	435	17-1/8	921	36-1/4	1022	40-1/4	347	765
350	14	845	33-1/4	559	22	476	18-3/4	1022	40-1/4	1124	44-1/4	465	1025
400	16	902	35-1/2	610	24	508	20	1105	43-1/2	1207	47-1/2	599	1320
450	18	1003	39-1/2	686	27	562	22-1/8	1232	48-1/2	1346	53	772	1700
500	20	832	32-3/4	762	30	606	23-7/8	1086	42-3/4	1213	47-3/4	1022	2250
600	24	1200	47-1/4	864	34	670	26-3/8	1505	59-1/4	1632	64-1/4	1544	2340



FABRICATED TEE STRAINERS

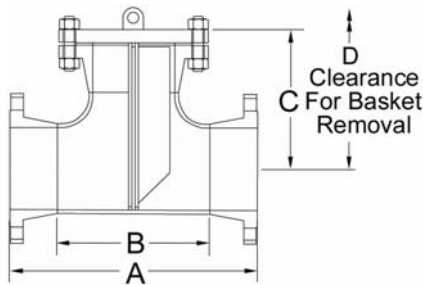

STYLE 1

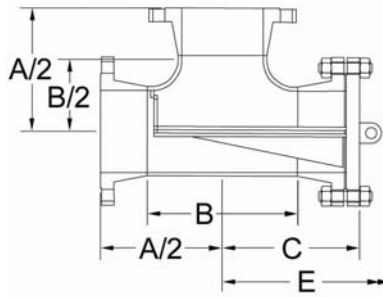

STYLE 2

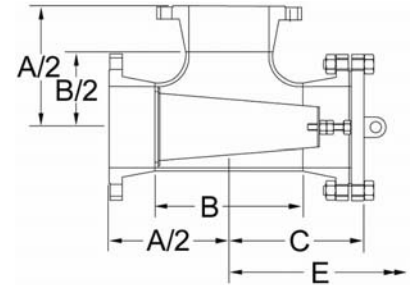

STYLE 3

DIMENSIONS AND WEIGHTS FOR SERIES 600T

Size		DIMENSIONS										Weight	
		A		B		C		D		E			
mm	in	mm	in	mm	in	mm	in	mm	in	mm	in	kg	lbs
50	2	286	11-1/4	127	5	175	6-7/8	311	12-1/4	349	13-3/4	24	52
80	3	349	13-3/4	172	6-3/4	213	8-3/8	387	15-1/4	425	16-3/4	45	100
100	4	425	16-3/4	210	8-1/4	257	10-1/8	476	18-3/4	530	20-7/8	86	190
125	5	489	19-1/4	248	9-3/4	295	11-5/8	552	21-3/4	613	24-1/8	134	295
150	6	533	21	286	11-1/4	321	12-5/8	610	24	676	25-5/8	166	365
200	8	635	25	356	14	379	14-15/16	737	29	813	32	263	580
250	10	749	29-1/2	432	17	445	17-1/2	876	34-1/2	965	38	409	900
300	12	832	32-3/4	508	20	489	19-1/4	984	38-3/4	1086	42-3/4	522	1150
350	14	902	35-1/2	559	22	527	20-3/4	1080	42-1/2	1181	46-1/2	672	1480
400	16	978	38-1/2	610	24	572	22-1/2	1181	46-1/2	1283	50-1/2	885	1950
450	18	1067	42	686	27	622	24-1/2	1295	51	1410	55-1/2	1112	2450
500	20	1156	45-1/2	762	30	673	26-1/2	1410	55-1/2	1537	60-1/2	1430	3150
600	24	1283	50-1/2	864	34	749	29-1/2	1588	62-1/2	1715	67-1/2	2088	4600

Notes:

- Dimensions shown are for flanged and butt-weld strainers. Dimensions can be modified to suit customer requirements
- Drains and differential tappings are optional
- Weights shown are for flanged end strainers only

ORDERING CODES

	ANSI CLASS	STRAINER TYPE	CONNECTION TYPE	BODY MATERIAL	COVER TYPE	CONSTRUCTION TYPE	STYLE
Example:	150	T	F	S	B	W	1
	150	T - Tee	F - Flanged	S - Carbon Steel	B - Bolted	W - Welded	1
	300		RTJ - Ring Joint	SS - 304 Stainless Steel	D - Bolted Cover With Davit		2
	600		BW - Butt-weld	SS6 - 316 Stainless Steel	H - Swing Bolt Hinged Cover		3
			G - Grooved	SSL - 304L Stainless Steel			
			TC - Tri-Clamp	SS6L - 316L Stainless Steel			
				(Other materials are available upon request)			

Colton has a policy of continuous product research and improvement and reserves the right to change design and specifications without notice



Tel: 1-888-300-9155 Fax: 1-888-300-9160 www.COLTONIND.com info@coltonind.com